



# PREFEITURA MUNICIPAL DE PARANAGUÁ

ESTADO DO PARANÁ

SECRETARIA MUNICIPAL DE SERVIÇOS URBANOS

GAFRE  
Fls. nº 37

Divisão de Arquivo Geral  
Fls. nº 214/0

## ANEXO I – PLANTA BAIXA – TERMINAL RODOVIÁRIO MUNICIPAL

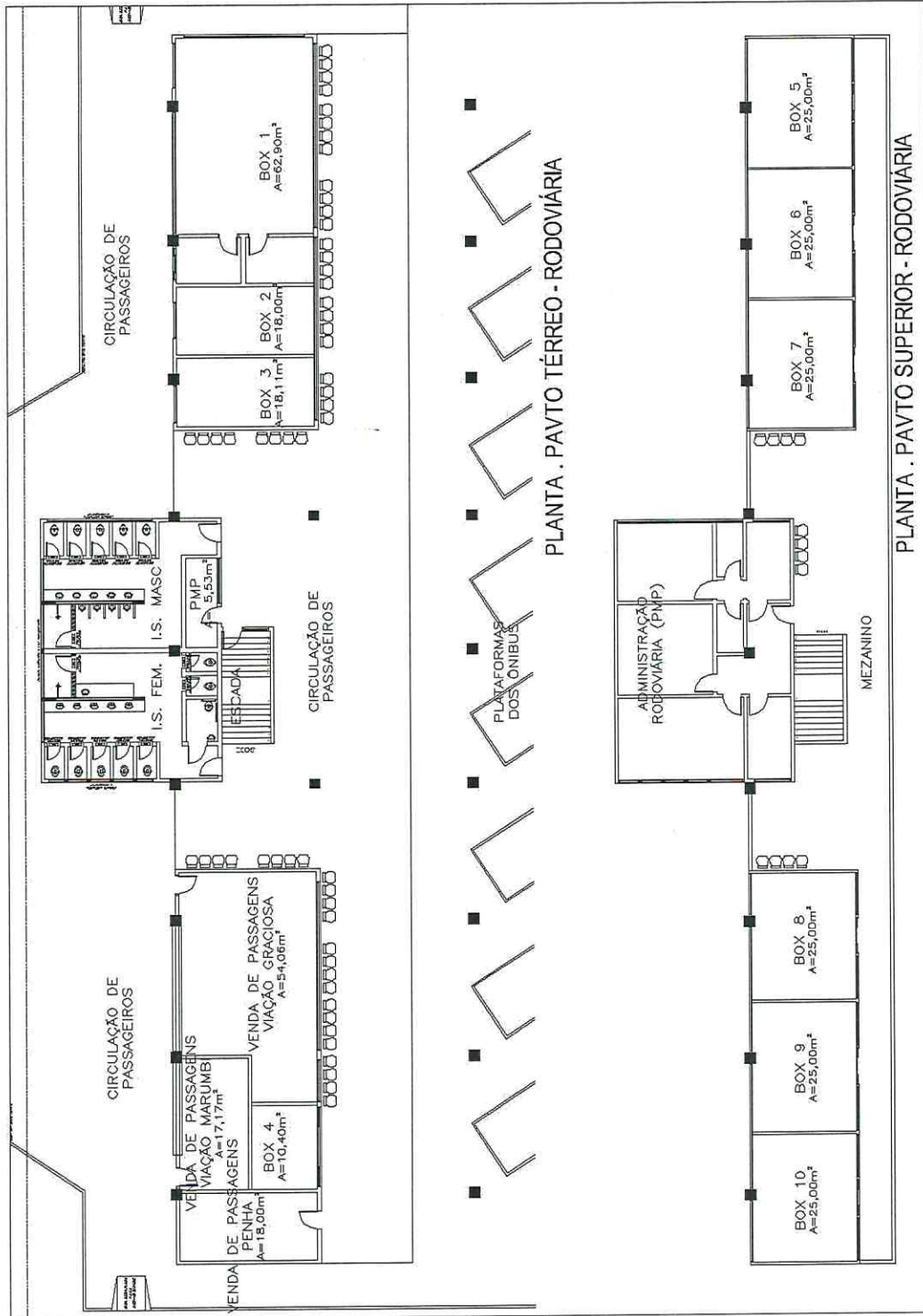

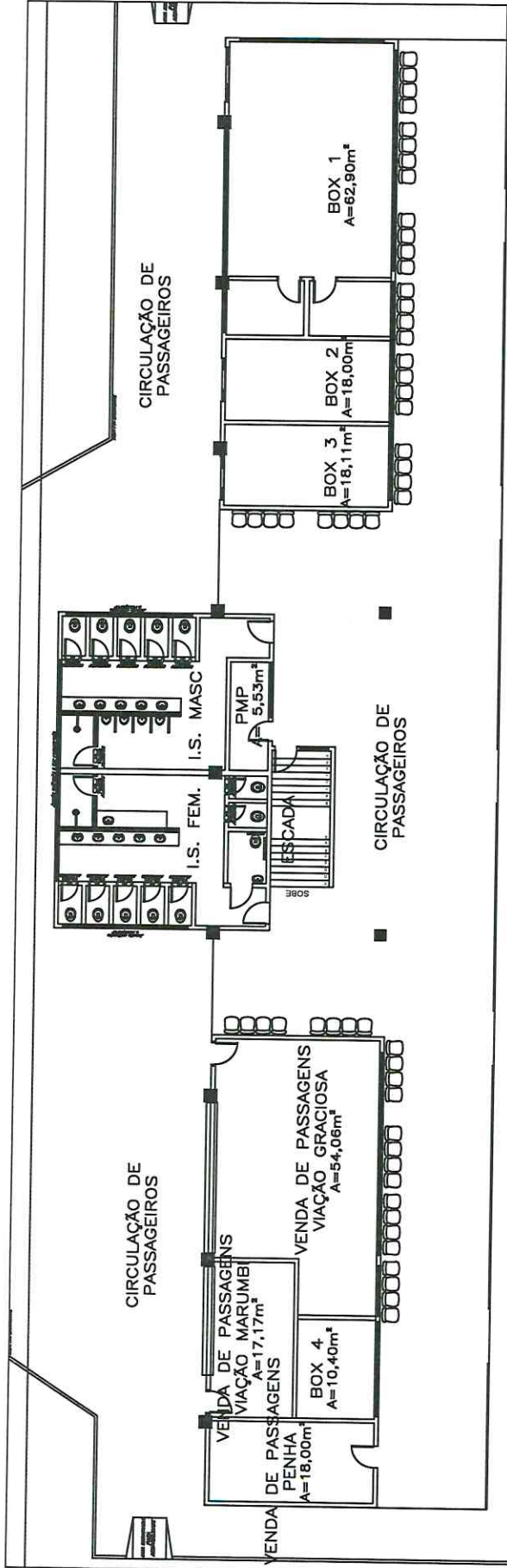

PLANTA . PAVTO TÉRREO - RODOVIÁRIA

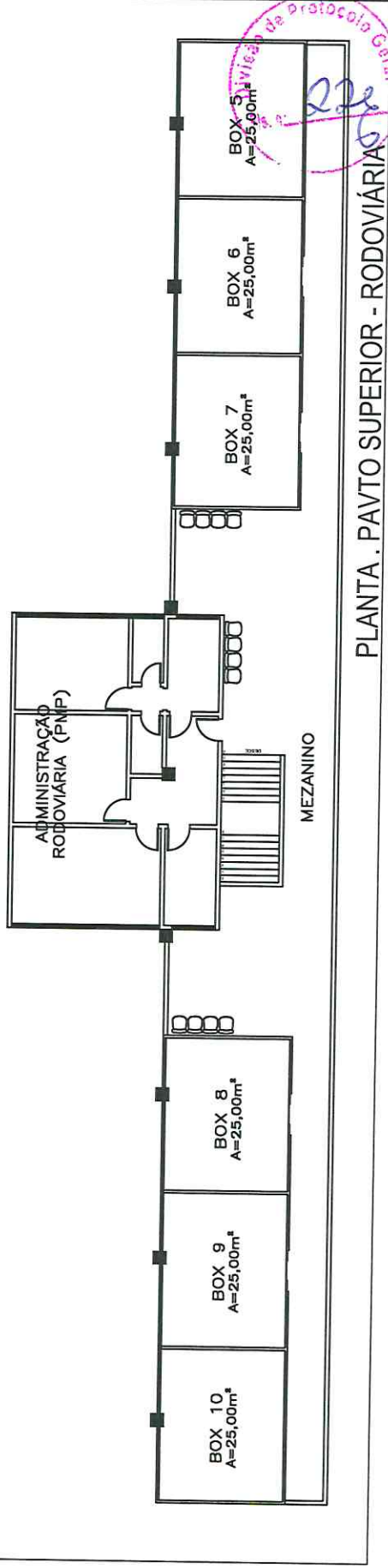

Divisão de protocolo CAPITEC

22

PLANTA . PAVTO SUPERIOR - RODOVIÁRIA